

**CONTINUOUS OR
SINGLE STEP CODE 4
LEAD FLASHING**

(AS L.S.A DETAIL)

**CODE 3 LEAD
SOAKER**

(AS L.S.A DETAIL)

15MM MAX

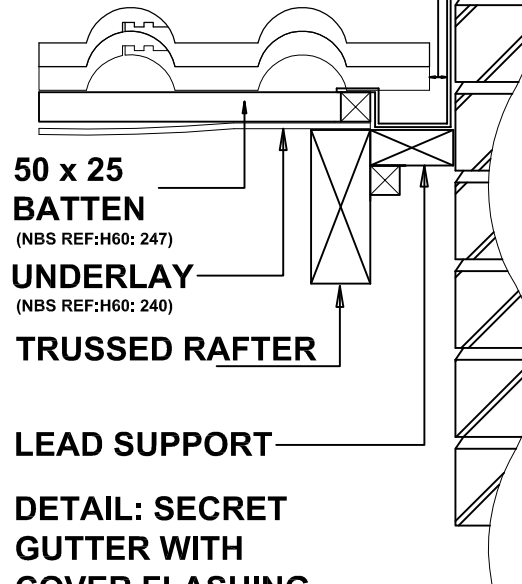

**50 x 25
BATTEN**

(NBS REF:H60: 247)

UNDERLAY

(NBS REF:H60: 240)

TRUSSED RAFTER

LEAD SUPPORT

**DETAIL: SECRET
GUTTER WITH
COVER FLASHING**

**RUSSELL ROOF TILES
SIDE ABUTMENT - STEP FLASHING
DOUBLE ROMAN
DR-SGC-07**